

# EDGESAFE®

## Smart Gate

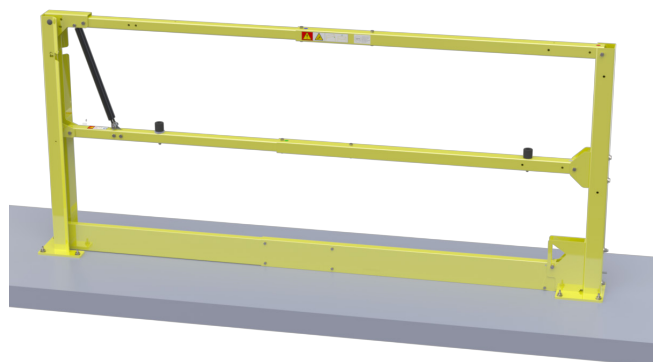

### Toeboard Installation Instructions



#### Models:

ESG-60-PCY

ESGDBL-120-PCY

ESG-96-PCY

ESGDBL-192-PCY

#### Table of Contents:

Safety Precautions .....	2
Product Information .....	2
ESG Size Reference Drawing.....	4
ESGDBL Size Reference Drawing.....	5
Existing Gate Installation Instructions .....	6
New Gate Installation Instructions.....	7
Replacement Parts List .....	12
Inspection and Maintenance.....	14
Warranty Certificate .....	15

### Contact Information

#### Mail

PS Safety Access  
1150 South 48th Street  
Grand Forks, ND 58201

#### Local Phone

701.746.4519

#### Website

pssafetyaccess.com

#### Hours of Operation

8 A.M. to 5 P.M. CT  
Monday – Friday

#### Toll Free Phone

877.446.1519

#### Email

4psinfo@psindustries.com

**IMPORTANT!** Read entire Instruction and Operations Manual to become familiar with the product.

**NOTICE** This product is designed to work with the EdgeSafe® Single and Paired Gates. The effectiveness of the product is directly related to the proper installation and operation of this product. Failure to properly maintain this product **will** affect performance.

#### Publication Notice

This manual has been compiled and published covering the latest product descriptions and specifications.

The contents of this manual and the specifications of this product are subject to change without notice.

PS Safety Access™ reserves the right to make changes without notice in the specifications and materials contained herein and shall not be responsible for any damages (including consequential) caused by reliance on the materials presented, including but not limited to typographical and other errors relating to the publication.

PS Safety Access and/or its respective suppliers may make improvements and/or changes in the product(s)/ service(s) offered and/or the program(s) at any time without notice.

Retain this manual for future reference.

If you would like a copy of this manual, please send an email to 4psinfo@psindustries.com

Product registration is an essential step to protecting your product, register Online at [psindustries.com/contact/register-your-product/](http://psindustries.com/contact/register-your-product/)



## Safety Precautions

The following icons are used throughout this Manual.

- ▲ DANGER** Indicates an imminently hazardous situation which, if not avoided, will result in death or serious injury.
- ▲ WARNING** Indicates a potentially hazardous situation which, if not avoided, could result in death or serious injury.
- ▲ CAUTION** Indicates a potentially hazardous situation which, if not avoided, may result in minor or moderated injury.
- NOTICE** Indicates manufacturer's statement of additional information.
- IMPORTANT!** Indicates a required action.
- CRITICAL** Indicates a vital component to product performance.

## Product Information

**NOTICE** Unauthorized modification of or to the Product voids this Limited Warranty. Authorized modifications, received in writing from PS Industries® Incorporated, as long as the modification is accomplished in strict accordance with PS Industries' instructions, does not void warranty. If this product is modified or altered without manufactures permission, manufacturer is no longer responsible for the product design, engineering, or performance and owner assumes all responsibility. To request product modifications contact PS Industries Incorporated, 1150 S. 48th Street, Grand Forks, ND 58201, phone 877-446-1519, email: 4psinfo@psindustries.com

### I. General Information

- A. This manual contains information regarding installation, operation, and maintenance of the PS Safety Access' Smart Gate.
- B. PS Safety Access recommends that the owner implement a regular preventative maintenance program to inspect and maintain the Smart Gate at a minimum, in accordance with the recommendations in this manual.

### II. Operation Guidelines

- A. The use of these toe board kits with ESG-60/96/120/244-PCY and ESGDBL-120-PCY Smart Gates are designed to meet:
  - 1. OSHA Railing Standard OSHA 1910.29, ANSI A1264.1-2017, Canada OHS SOR-86-304 Part II, and ISO 14122-3:2016.
- B. The ESGDBL-192-PCY Smart Gate with installed toe boards is not rated for fall protection applications.
- C. Operation in a manner other than intended could result in damage or less than acceptable performance at time of need, for which the manufacturer will not be held responsible.

### III. Safety Precautions

- A. Ensure opening is clear of all obstructions through the entire proposed travel of the Smart Gate during operation.
- B. Comply with all OSHA and ANSI Safety Regulations and/or company safety policies when installing.
- ▲ DANGER** If installed on edge, ensure area below installation edge is blocked off from personnel during installation.
- ▲ DANGER** Ensure mounting surface is capable of supporting all loading. Structural analysis of mounting surface is the responsibility of the owner.
- IMPORTANT!** Verification of the structural sufficiency of supplied anchors based on site specific conditions and the existing structure is the responsibility of the installer/customer. Refer to the anchor manufacturer's installation instructions for installation requirements.

### IV. Storage Prior to Installation of Product

- A. Store materials in a dry, ventilated location. If outdoor storage is required, block materials and tarp in a tent-like arrangement, elevated above the product with open sides to allow airflow.

### V. Installation Site Preparation

- NOTICE** Before starting site preparation and installation of the Smart Gate, read the entire Operation and Maintenance Manual and review Approved for Construction Drawings and all additional installation instructions thoroughly.
- A. Clear work area of any debris.

## Product Information

- B. Ensure you have the necessary tools available.
- C. Obtain all required permits.
- D. Personnel: Determine the appropriate number of personnel required to perform installation and have them readily available at the project site.
- E. Ensure all installation personnel utilize appropriate fall protection equipment and procedures during installation.

### VI. Recommended Tools for Installation:

#### A. Tools:

- 1. One (1) Drill for Anchoring
- 2. Two (2)  $\frac{9}{16}$ " Socket and Ratchets
- 3. Two (2)  $\frac{7}{16}$ " Socket and Ratchets
- 4. One (1) Rubber Mallet
- 5. One (1) Tape Measure

### VII. Toe Board Kit Parts List

- A. Review inventory to ensure all parts are present for assembly/installation. Refer to parts list below.

**Toe Board Kit Part List  
(As Shipped)**

ITEM #	DESCRIPTION	QTY
1	ESG;TOE BOARD POST MOUNT RIGHT PCY	1
2	ESG;TOE BOARD POST MOUNT LEFT PCY	1
3	ESG;TOE BOARD PIVOT PLATE PCY	1
4	ESG;5.1" TOE BOARD PCY	1
5	ESG;4.9" TOE BOARD PCY	1
6	ESG/TOE BOARD TIP PCY	1
7	ESG;TOE BOARD LEG PCY	1
8	ESG;TOE BOARD HARDWARE BAG	1
9	ESG;DAMPENER # W/ENDS	1
*10	ESG;DAMPENER # W/ENDS	1

\*Second Dampener included ONLY on 96" Toe Board Kit.

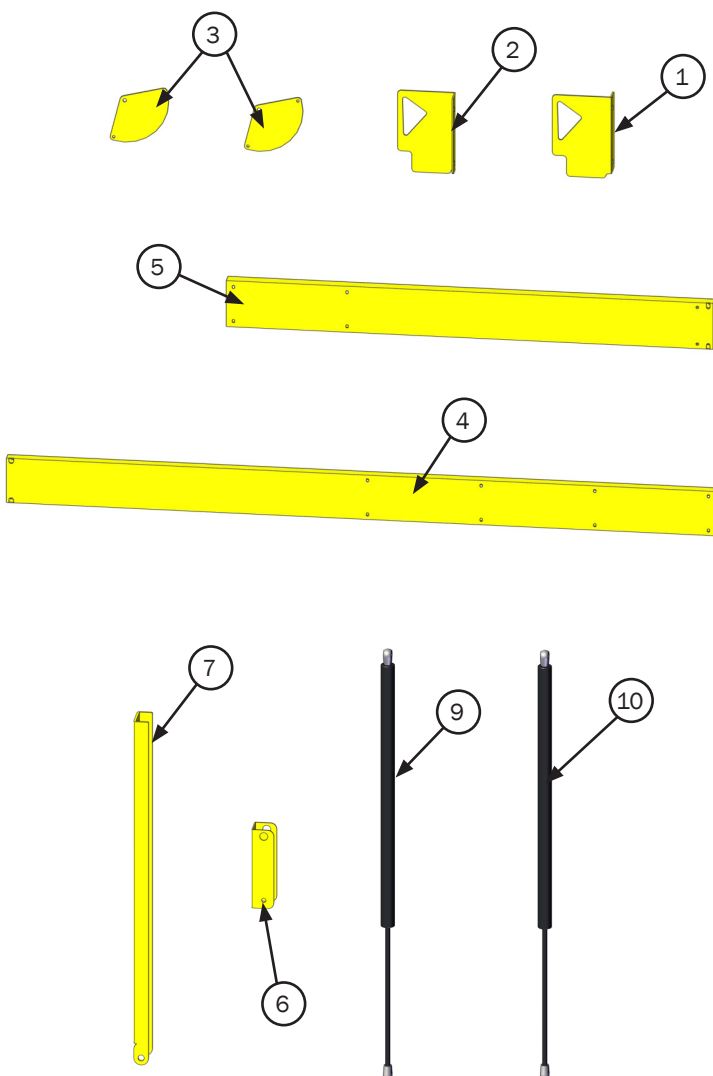
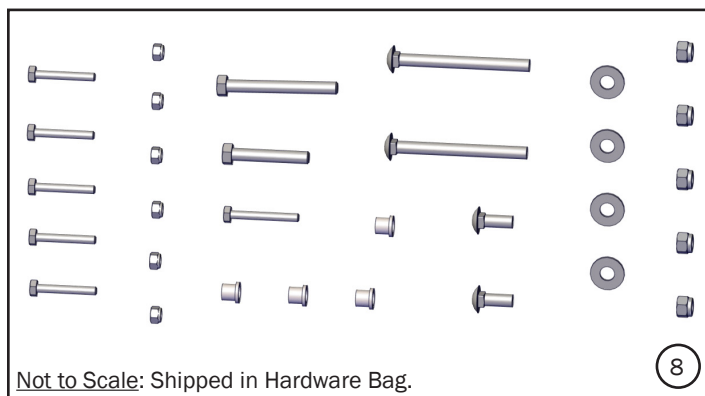

ESG Size Reference Drawing

VIII. ESG Size Reference Drawing

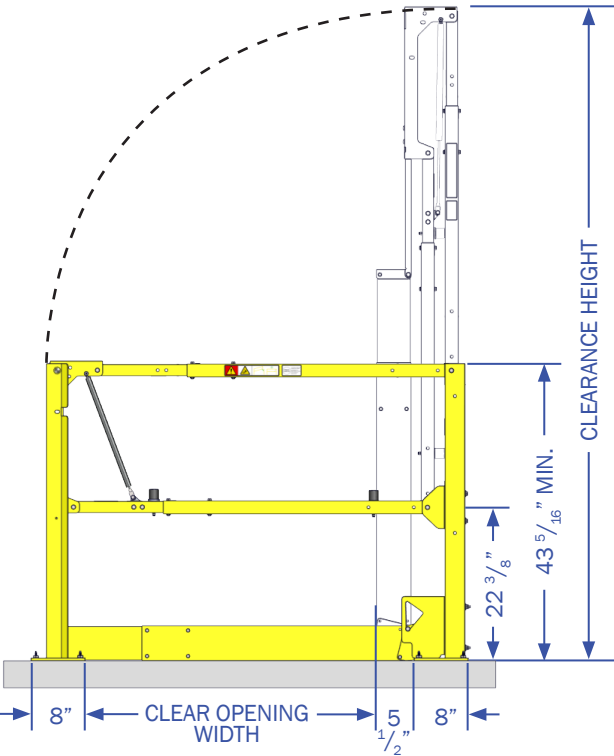

FRONT VIEW

ESG Size Reference Table			
GATE MODEL	CLEAR OPENING WIDTH	CLEARANCE HEIGHT	OVERALL GATE WIDTH
ESG-60-PCY w/Toe Board  Part #: 515187 QTY 1	42 1/2"	95 1/2"	64"
	48 1/2"	101 1/2"	70"
	54 1/2"	107 1/2"	76"
	60 1/2"	113 1/2"	82"
	66 1/2"	119 1/2"	88"
ESG-96-PCY w/Toe Board  Part #: 515187 QTY 1	72 1/2"	125 1/2"	94"
	78 1/2"	131 1/2"	100"
	90 1/2"	153 1/2"	112"
	102 1/2"	164 1/2"	124"

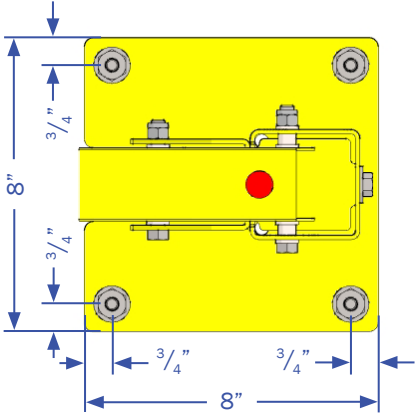

DETAIL A

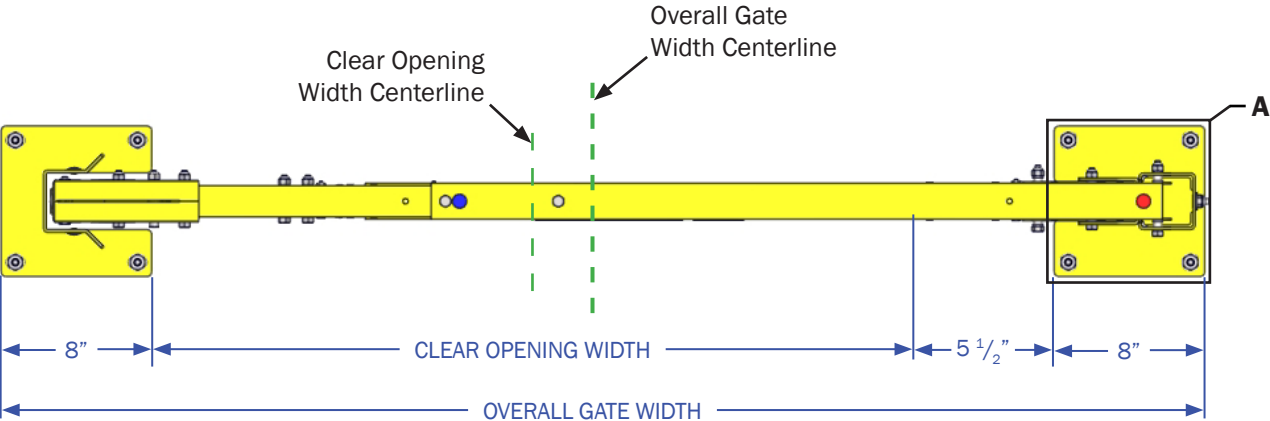

TOP VIEW

# ESGDBL Size Reference Drawing

## IX. ESGDBL Size Reference Drawing

ESGDBL Size Reference Table			
GATE MODEL	CLEAR OPENING WIDTH	CLEARANCE HEIGHT	OVERALL GATE WIDTH
ESGDBL-120-PCY w/Toe Board  Part #: 515186 QTY 2	97"	95 1/2"	124"
	103"	101 1/2"	130"
	109"	101 1/2"	136"
	115"	107 1/2"	142 "
	121"	107 1/2"	148"
	127"	113 1/2"	154"
	133"	113 1/2"	160"
	139"	119 1/2"	166"
	145"	119 1/2"	172"
	151"	125 1/2"	178"
ESGDBL-192-PCY w/Toe Board  Part #: 515187 QTY 2	169"	131 1/2"	196"
	181"	153 1/2"	208"
	193"	153 1/2"	220"
	205"	164 1/2"	232"
	217"	164 1/2"	244"

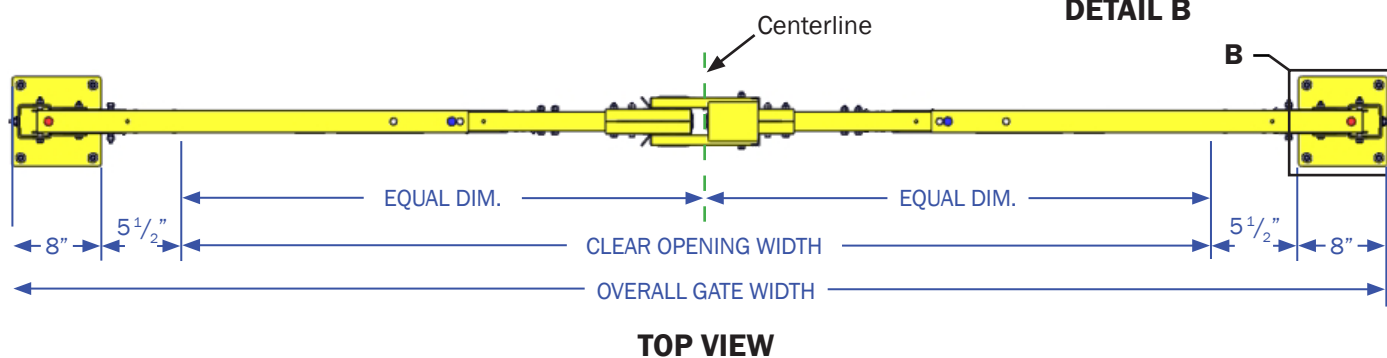
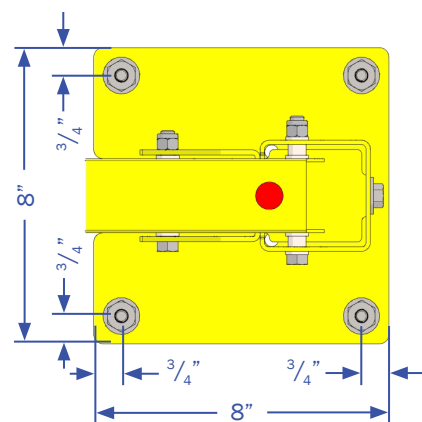
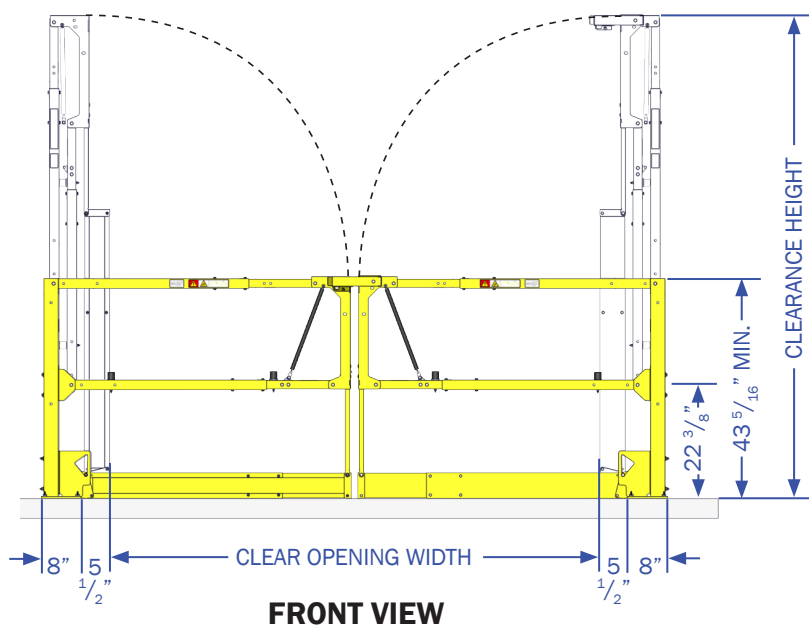

## Installation

### X. Installation of Toe Board on an Existing Gate.

- A. If disassembling Existing Smart Gate complete depressurization process and continue with remaining steps.
- B. For new gate installation with Toe Boards, skip ahead to Step 6 on Page 7.

**▲ DANGER** SYSTEM UNDER HIGH PRESSURE! Refer to depressurization instructions in Operation and Maintenance Manual before doing any maintenance on the gate.

**STEP 1.** With gate in the closed position (gate arms horizontal).

- a. Remove only the leading  $\frac{3}{8}$ " hex bolt and nylock nut from Dampener Mount Link (as shown in Illustration).

**Step 1  
Illustration I**

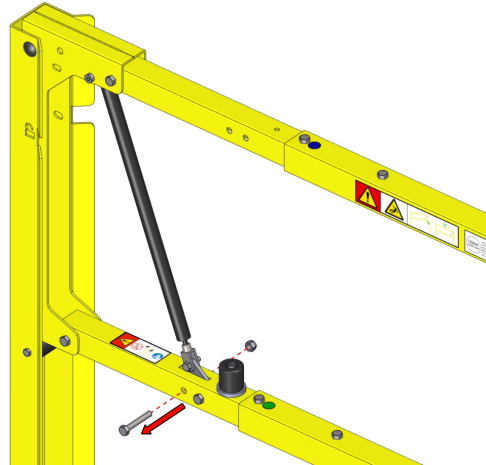

**STEP 2.** Open or lift gate to the “open” position (gate arms vertical) before proceeding with Step 3.

- a. You will hear a click as the link rocks out of position, this is normal during the disassembly step.

**▲ WARNING** High internal gate forces! Before removing Gate Post base plate fasteners, the gate must be in the open position (gate arms vertical) so the dampener is in a non-compressed state.

**STEP 3.** With the Gate in the “open” position, remove the anchor nuts on the Gate Post.

- a. Use team lift to lay on the ground as shown for improved access during dampener installation.

**NOTICE** To protect the Powder Coat finish, lay on cardboard.

**▲ WARNING** The Smart Gates are heavy. Verify weights and use appropriate lifting procedures and equipment.

**STEP 4.** Carefully remove spacers, bolts, and nuts from Dampener end.

- a. For ESG-60-PCY Gates refer to Illustration I.
- b. For ESG-96/120/144-PCY Gates refer to Illustration II.

**Step 4  
Illustration I**

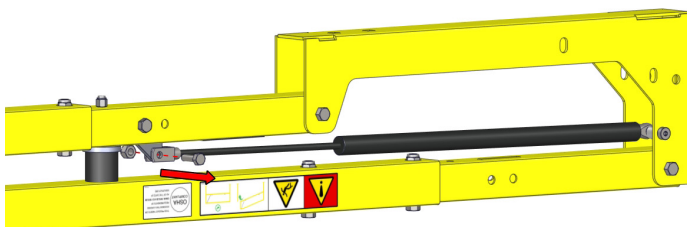

**Step 4  
Illustration II**

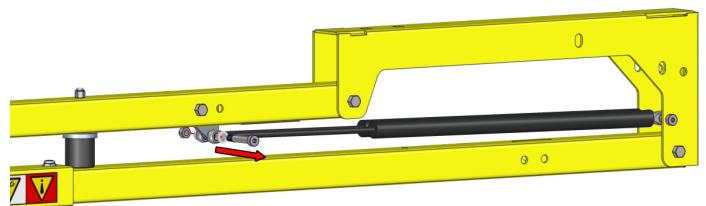

**STEP 5.** Remove the  $\frac{3}{8}$ " shoulder bolt, spacer(s), and nut from the other end of the Dampener.

# Installation

## XI. Installation of Toe Board on a new Gate Install.

A. If disassembling Existing Smart Gate first complete depressurization process on Page 6 before continuing with Toe Board Installation.

**STEP 6.** Determine the dampener recommended for your Clear Opening (refer to reference table below).

- Install dampener first into the Gate End with  $\frac{3}{8}$ " shoulder bolt
- Carefully assemble spacers, bolts, and nuts per images shown.
  - For ESG-60-PCY/ESGDBL-120-PCY Gates refer to Illustrations I and II.
  - For ESG-96-PCY/ESGDBLE-192-PCY Gates refer to Illustrations III and IV.

Recommended Dampener Reference Table			
GATE MODEL	CLEAR OPENING WIDTH	INCLUDED W/ ESG	INCLUDED W/ TB KIT
ESG-60-PCY w/Toe Board	42 $\frac{1}{2}$ "	514163	
	48 $\frac{1}{2}$ "	514163	
	54 $\frac{1}{2}$ "		513918
	60 $\frac{1}{2}$ "		513918
	66 $\frac{1}{2}$ "		513918
	72 $\frac{1}{2}$ "		513918
ESG-96-PCY w/Toe Board	78 $\frac{1}{2}$ "	513918	513462
	90 $\frac{1}{2}$ "	513918	513718
	102 $\frac{1}{2}$ "		513462 513718

**Step 6  
Illustration I**

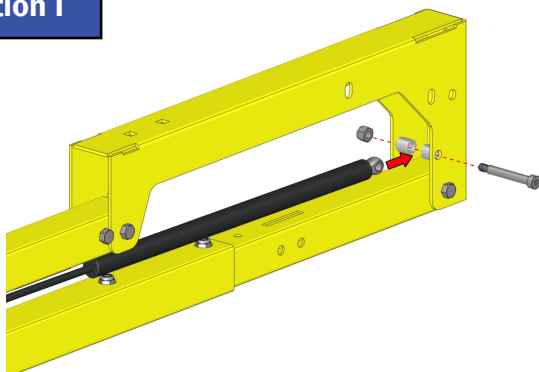

**Step 6  
Illustration II**

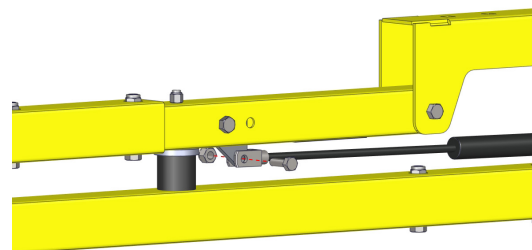

**Step 6  
Illustration III**

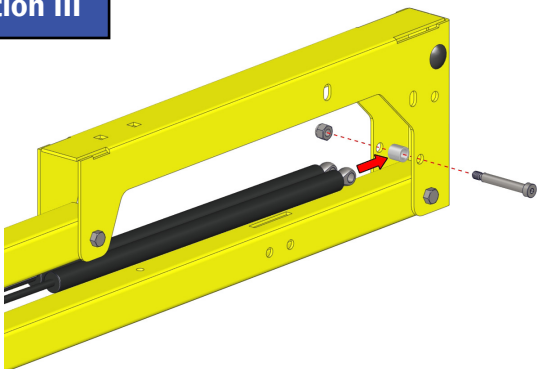

**Step 6  
Illustration IV**

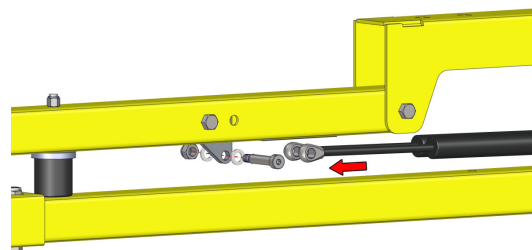

## Installation

**STEP 7.** Remove Bumper Shelf Hardware from Catch Post, if previously installed.

### Step 7 Illustration I

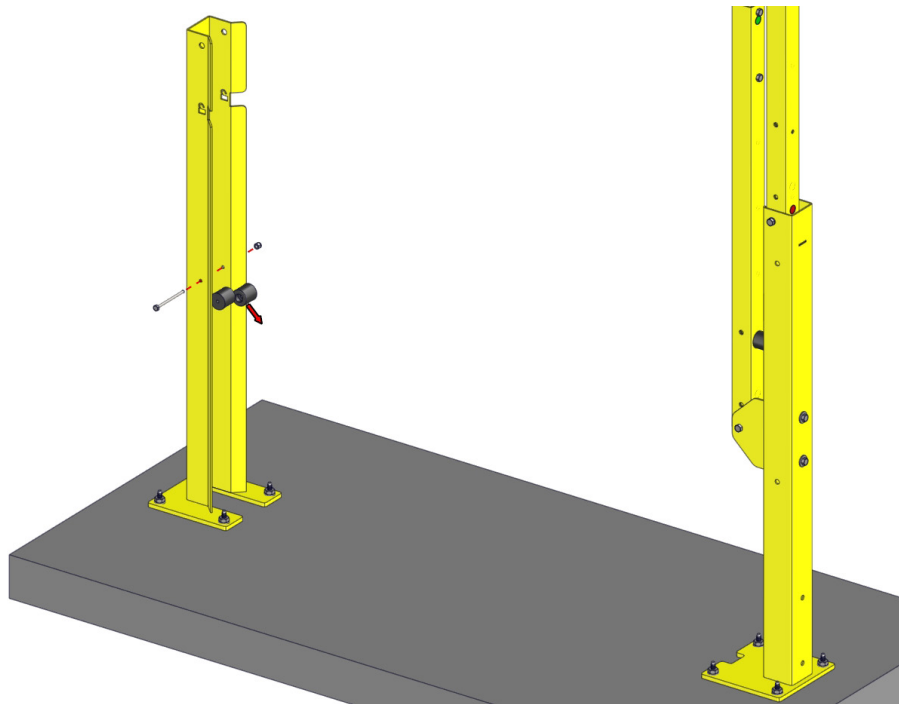

**⚠ WARNING** This step requires multiple personnel and safe lifting techniques and/or equipment as required.

**STEP 8.** Safely lift and place the gate on the concrete anchors, level the post, and tighten anchor nuts; leave Gate vertical.

**STEP 9.** Loosely attach both Left and Right Post Mounts to Gate Post with carriage bolts, washers, and nylock nuts.  
a. Left Post Mount lines up inside of Right Post Mount (refer to Illustration I).

### Step 9 Illustration I

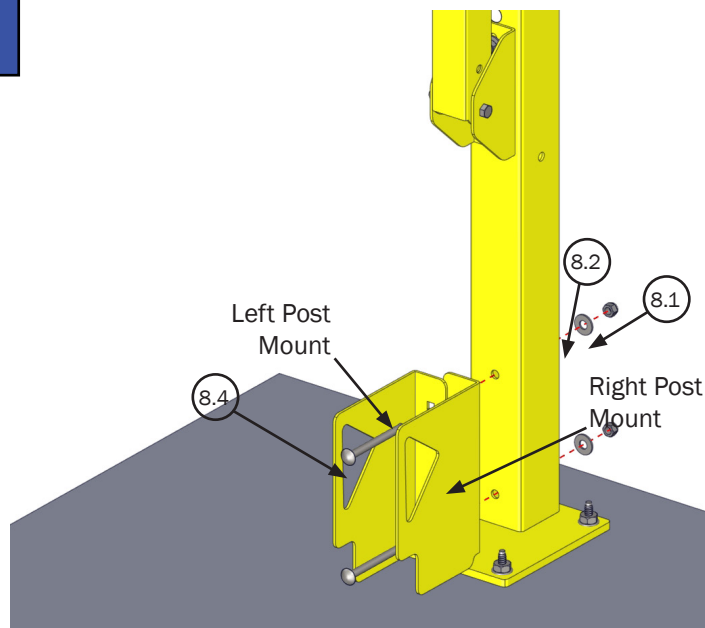



## Installation

**STEP 10.** Assemble pivot plates to larger Toe Board using supplied  $\frac{1}{4}$ " bolt and nylock nut (only can be assembled on one side of Toe Board as shown in Illustration I).

a. Attach assembled large Toe Board to Post Mounts with  $\frac{3}{8}$ " bolt, two (2) flange bearings, and nylock nut.

**Step 10  
Illustration I**

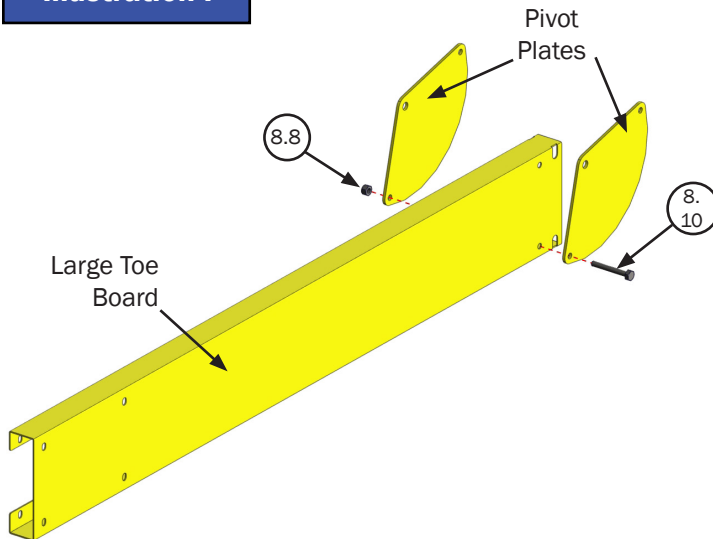

**Step 10  
Illustration II**

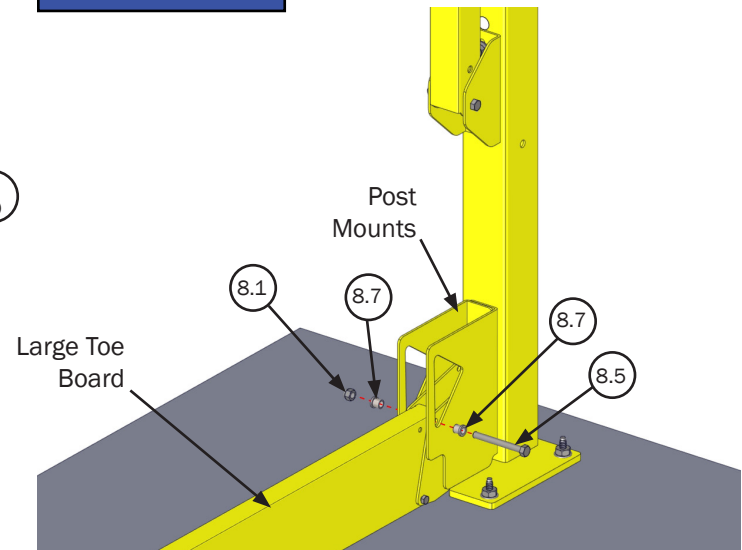

**STEP 11.** The face of the toe board can face towards either side of the gate opening as the installer deems appropriate for their application.

a. Slide Toe Board Tip onto Small Toe Board and fasten with supplied  $\frac{1}{4}$ " bolt and nylock nut.

b. Use rubber mallet to gently hammer flange bearings into top of Toe Board Tip.

c. Attach Toe Board Leg to Toe Board Tip and secure with  $\frac{3}{8}$ " bolt and nylock nut.

d. Tighten the carriage bolts that connect the Post and the Post Mounts.

**Step 11  
Illustration I**

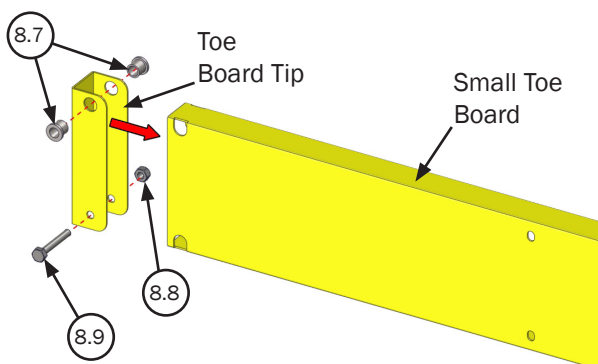

**Step 11  
Illustration II**

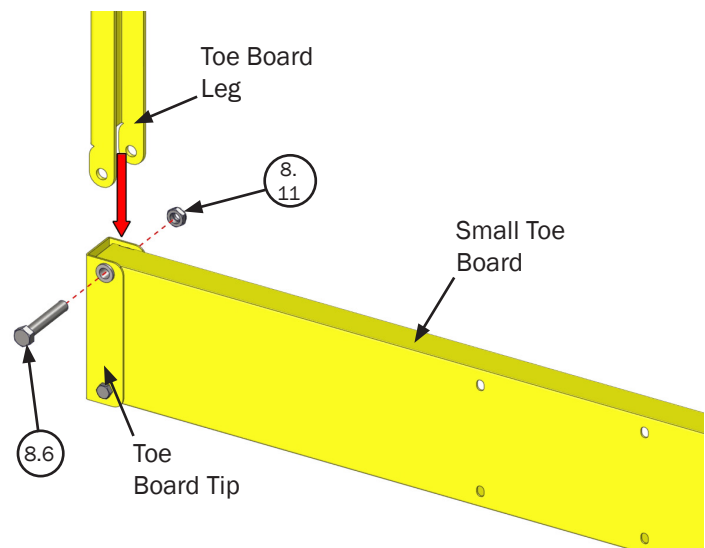

## Installation

- STEP 12.** Slide Small Toe Board Section into Large Toe Board section and adjust width to match installed gate width.
- Once desired width has been determined, connect Toe Board sections using  $\frac{1}{4}$ " bolts and nylock nuts.

**Step 12  
Illustration I**

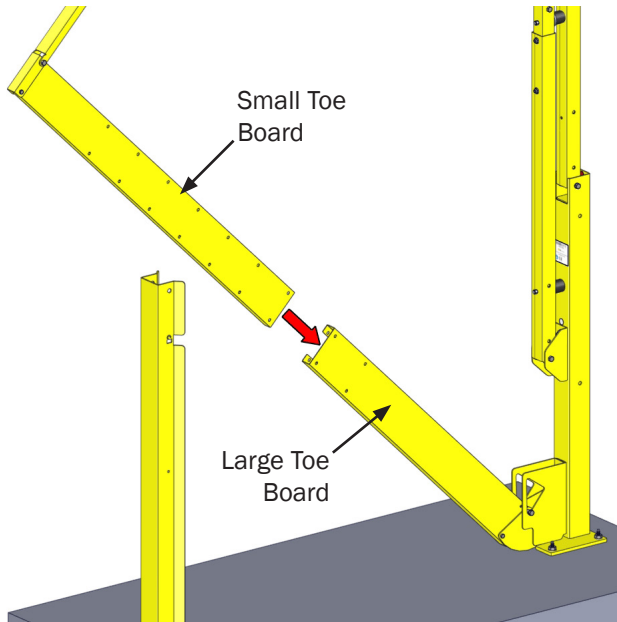

**Step 12  
Illustration II**

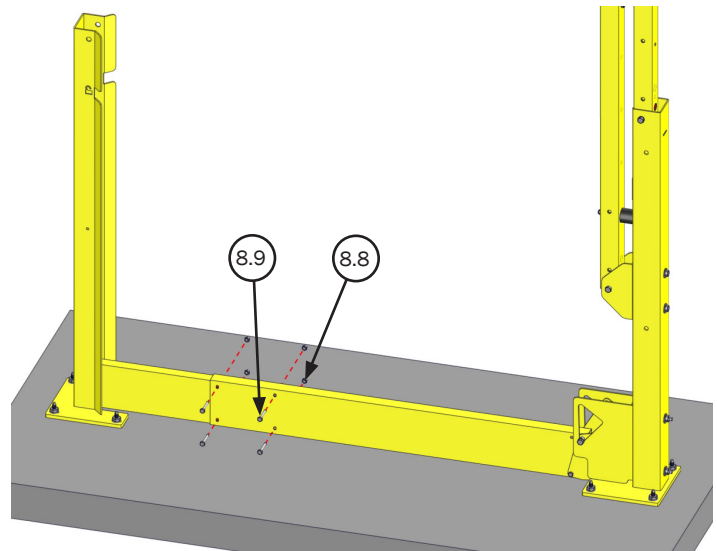

- STEP 13.** Lower gate and attach Toe Board Leg into Gate end using short  $\frac{3}{8}$ " carriage bolts, washers, and nylock nuts.
- It may be necessary to have additional personnel to assist in holding Gate in place.

**Step 13  
Illustration I**

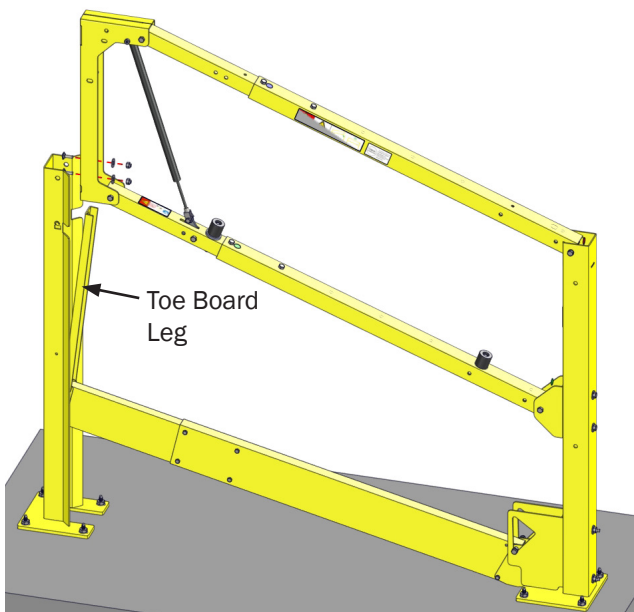

**Step 13  
Illustration II**

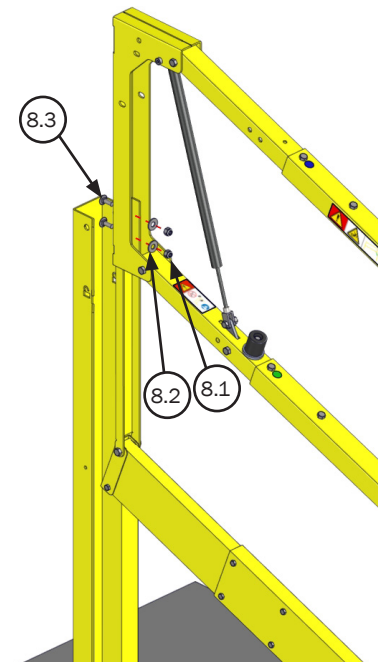

## Installation

**STEP 14.** Lower the Gate to its lowered position and resting in the Catch Post

- a. As the gate approaches fully closed, you should hear a loud “click” noise of the dampener self-setting.

**STEP 15.** Visually verify that the dampener and dampener link self-set into the appropriate location.

- a. Insert  $\frac{3}{8}$ " hex bolt and tighten nylock nut.

**▲ DANGER** KEEP FINGERS CLEAR OF DAMPENER PIVOT POINTS, DAMPENER IS UNDER HIGH PRESSURE!

**Step 15  
Illustration I**

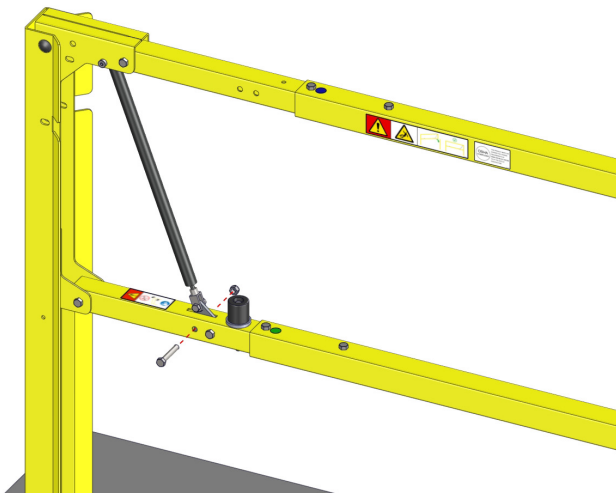

**Step 15  
Illustration I**

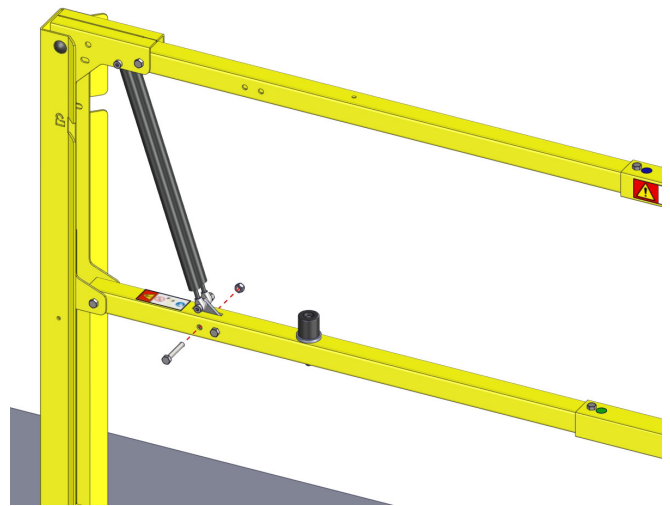

**STEP 16.** Repeat Step 1 through Step 15 for other Smart Gate Assembly (If installing Toe Board Kits on Paired Gates).

**STEP 17.** Final adjustments of Smart Gate.

- a. Raise, lower, and adjust per Step 16 of ESG O&M or Step 17 of ESGDBL O&M.

**Step 17  
Illustration I**

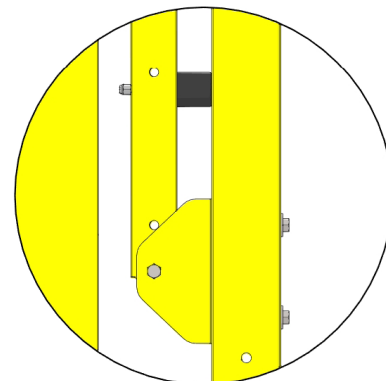
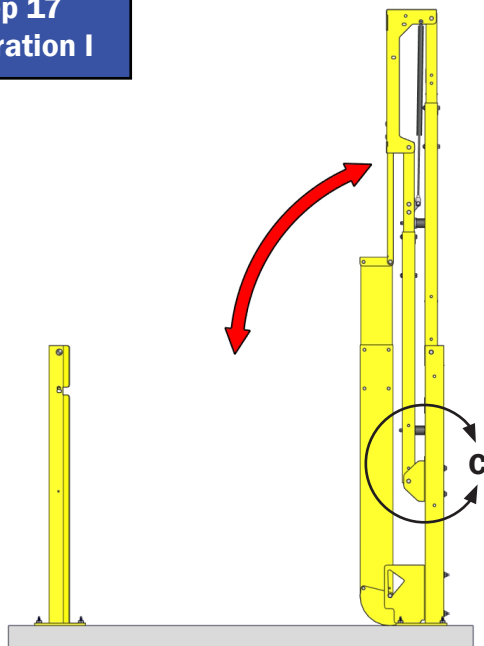

**DETAIL C**

## Replacement Parts List

### XII. Replacement Parts List

- A. This Replacement Parts List is for all EdgeSafe™ Toe Board Kits.  
 B. The Replacement Parts Diagrams are located on Page 13.

Finish Options	
PCY	Powder Coat Safety Yellow

60" Toe Board Kit (Part # 515186) Replacement Parts List				96" Toe Board Kit (Part # 515187) Replacement Parts List			
ITEM #	DESCRIPTION	QTY	PART #	ITEM #	DESCRIPTION	QTY	PART #
1	ESG;TOE BOARD POST MOUNT RIGHT PCY	1	515192	1	ESG;TOE BOARD POST MOUNT RIGHT PCY	1	515192
2	ESG;TOE BOARD POST MOUNT LEFT PCY	1	515190	2	ESG;TOE BOARD POST MOUNT LEFT PCY	1	515190
3	ESG;TOE BOARD PIVOT PLATE PCY	2	515194	3	ESG;TOE BOARD PIVOT PLATE PCY	2	515194
4	ESG;5.1" TOE BOARD 5FT PCY	1	515200	4	ESG;5.1" TOE BOARD 8FT PCY	1	515204
5	ESG;4.9" TOE BOARD 5FT PCY	1	515202	5	ESG;4.9" TOE BOARD 8FT PCY	1	515206
6	ESG;TOE BOARD TIP PCY	1	515196	6	ESG;TOE BOARD TIP PCY	1	515196
7	ESG; TOE BOARD LEG PCY	1	515198	7	ESG; TOE BOARD LEG PCY	1	515198
8	ESG;TOE BOARD HARDWARE BAG	1	515188	8	ESG;TOE BOARD HARDWARE BAG	1	515188
8.1	NUT;NYLOCK 3/8"16 ZN	5	501120	8.1	NUT;NYLOCK 3/8"16 ZN	5	501120
8.2	WASHER;FLAT 3/8" ZN	4	501947	8.2	WASHER;FLAT 3/8" ZN	4	501947
8.3	BOLT;CARRIAGE 3/8"16X1" GR5ZN	2	515339	8.3	BOLT;CARRIAGE 3/8"16X1" GR5ZN	2	515339
8.4	BOLT;CARRIAGE3/8"16X4GR5ZN	2	515249	8.4	BOLT;CARRIAGE3/8"16X4GR5ZN	2	515249
8.5	BOLT;HEX3/8"16X3-1/4GR5ZN	1	502933	8.5	BOLT;HEX3/8"16X3-1/4GR5ZN	1	502933
8.6	BOLT;HEX3/8"16X2 1/4GR5ZN	1	500405	8.6	BOLT;HEX3/8"16X2 1/4GR5ZN	1	500405
8.7	BEARING;FLANGE STAINLESS	4	514921	8.7	BEARING;FLANGE STAINLESS	4	514921
8.8	NUT;NYLOCK 1/4"20 ZN	6	501113	8.8	NUT;NYLOCK 1/4"20 ZN	6	501113
8.9	BOLT;HEX1/4"20X1 3/4GR5ZN	5	506661	8.9	BOLT;HEX1/4"20X1 3/4GR5ZN	5	506661
8.10	BOLT;HEX1/4"20X2GR5ZN	1	500378	8.10	BOLT;HEX1/4"20X2GR5ZN	1	500378
8.11	NUT;NYLOCK JAM 3/8"16 ZN	1	501125	8.11	NUT;NYLOCK JAM 3/8"16 ZN	1	501125
9	ESG;DAMPENER 8 W/ CLEVIS ENDS	1	513918	9	ESG;DAMPENER 10 W/ CLEVIS ENDS	1	513462
				10	ESG;DAMPENER 12 W/CLEVIS ENDS	1	513718

**TO ORDER PARTS CONTACT PS SAFETY ACCESS AT  
 877.446.1519 or [4psinfo@psindustries.com](mailto:4psinfo@psindustries.com)**

## Replacement Parts Diagram

### XIII. Replacement Parts Diagram

- A. These Replacement Parts Diagrams for all EdgeSafe™ Toe Board Kits.  
 B. The Replacement Parts List is located on Page 12.

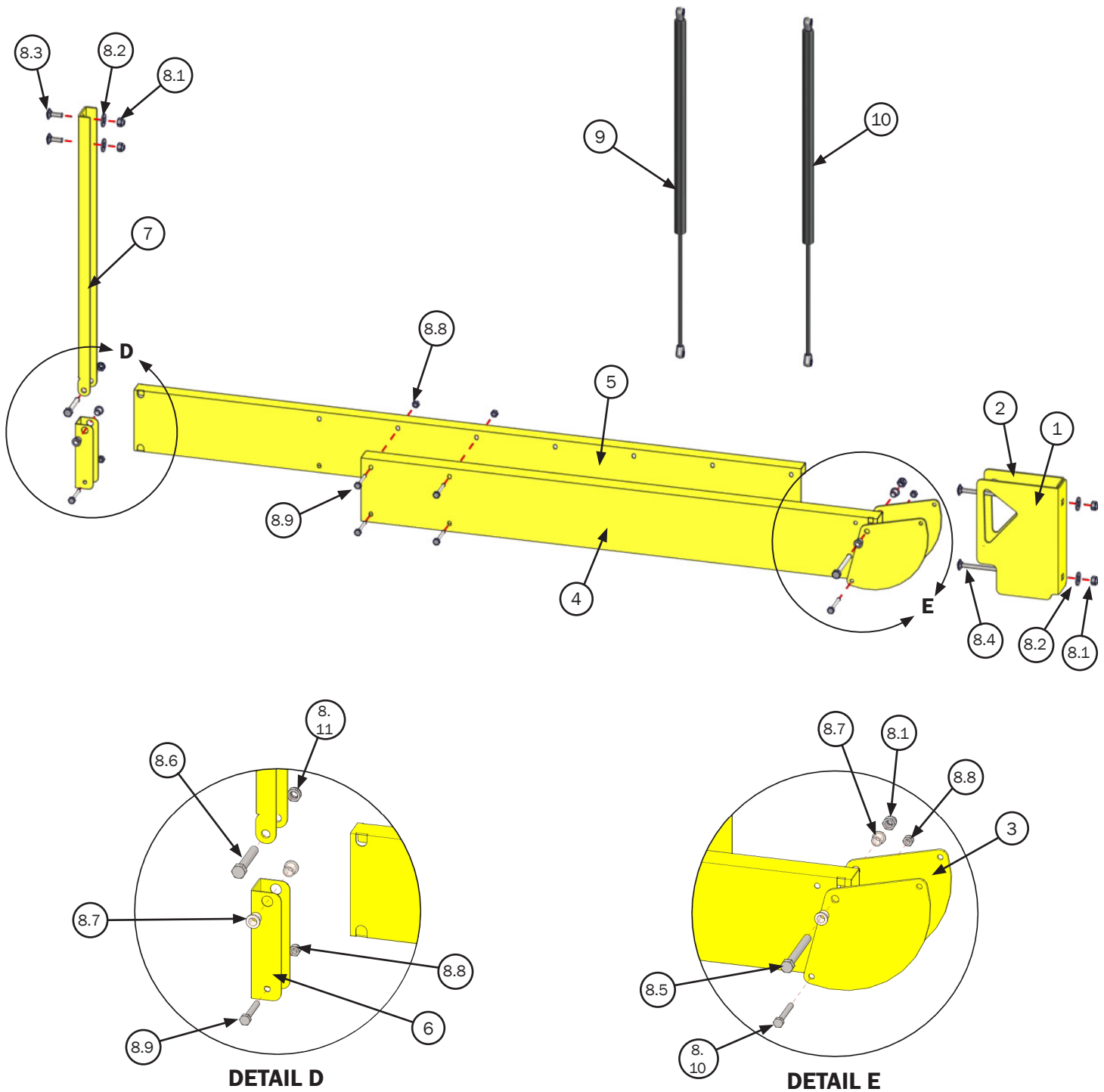

## Inspection and Maintenance

### XIV. Inspection and Maintenance

- A. Environmental conditions may affect the maintenance and repair requirements of the product, and recommended preventative maintenance frequency.
- B. If any of the inspection items are found to not meet the standard IMMEDIATELY “TAG OUT” the EdgeSafe® Smart Gate removing it from active use and guard the opening until repairs are completed.

**NOTICE** PS Safety Access recommends that the owner implement a regular and preventative maintenance program to inspect and maintain Smart Gate at a minimum, in accordance with the recommendations in the table below.

**▲ WARNING** While performing maintenance and inspection ensure personnel utilize appropriate fall protection equipment and procedures.

Recommended Preventative Maintenance					
ITEM	FREQUENCY	ITEM DESCRIPTION	WHAT TO INSPECT	STANDARD	REPAIR ACTION
1	Each Use	General Housekeeping	Opening	Opening must be kept free of debris and obstructions.	Always keep area clean.
2	Weekly	Gate	Gate for corrosion or damage.	To protect the structural integrity and provide engineered safety protection.	Touch up finishes, or refinish as necessary.
			Welds	Welds are intact without visible cracks or crazing.	Repair or Replace component immediately.
			Gate alignment and free movement.	Gate must move freely without any interference; levelness from ground/ walking surface.	Adjust gate as necessary.
3	Weekly	Posts	Post assemblies for corrosion or damage.	To protect the structural integrity and provide engineered safety protection.	Touch up finishes, or refinish as necessary.
			Welds	Welds are intact without visible cracks or crazing.	Repair or Replace component immediately.
4	Monthly	Structural Attachment	All Fasteners (Structural Attachment)	Fasteners must be present and be Snug Tight; connections pulled into firm contact by the fastener, no gaps between material.	Tighten fasteners to snug tight. Replace any missing fasteners.
5	Monthly	Dampener	Dampener for free movement and no corrosion or damage.	Must be free of all debris, operates smoothly without interference.	Replace if damage or deterioration to Dampener has occurred. Use only Factory approved products.
			Self-lubrication	Must be well lubricated.	Run Dampeners through full stroke length to re-lubricate.
6	Monthly	Labels	All labels	Manufacturer's labels in place and legible.	Replace. Contact manufacturer for FREE replacement labels.

## PS INDUSTRIES® INCORPORATED – LIMITED WARRANTY

**Limited Warranty:** Subject to the terms of this Limited Warranty, PS Industries® Incorporated warrants to the original user or consumer (the "Owner") of a PS Industries product (the "Product") that, for a period of one (1) year from date of shipment, the Product will be free from defects in material and workmanship under normal use and service, and provided the Product is installed, operated and maintained in accordance with instructions supplied by PS Industries. The terms and limitations of this Limited Warranty apply to all repaired or replacement Products for a term equal to the balance of the warranty remaining on the Product that was repaired or replaced as of the date of such repair or replacement. Register online at: [www.psindustries.com/contact/register-your-product](http://www.psindustries.com/contact/register-your-product)

**PS Flood Barriers™ Product Warranty Registration:** For PS Flood Barriers™ Products, this Limited Warranty will only be valid if the Owner completes the Warranty Registration Form provided within thirty (30) days of Product installation. To request a copy of the Warranty Registration Form, contact PS Industries Incorporated, 1150 S. 48th Street, Grand Forks, ND 58201, phone 877-446-1519, email: [4psinfo@psindustries.com](mailto:4psinfo@psindustries.com). Register online at: [www.psindustries.com/contact/register-your-product/](http://www.psindustries.com/contact/register-your-product/) Additional Warranty Registration Forms can be downloaded at [www.psfloodbarriers.com/download-center/](http://www.psfloodbarriers.com/download-center/)

**Warranty Exclusions:** Notwithstanding anything to the contrary, this Limited Warranty does not cover any of the following:

1. Normal wear and tear (including, but not limited to, normal wear and tear to gaskets and weather seals); damage or accidents resulting from freight damage, from failure to follow precautionary safety measures, or applied paint failure; abuse, misuse or unauthorized modification of the Product; misapplication; improper installation; or any defects, damage or other harm that is not the result of the acts or omissions of PS Industries.
2. Cost of field labor or other charges incurred by Owner in removing and/or re-affixing the Product or any part or component thereof.
3. Transportation costs.

Unauthorized modification of or to the Product voids this Limited Warranty. Authorized modifications, received in writing from PS Industries, as long as the modification is accomplished in strict accordance with PS Industries' instructions, does not void warranty. To request product modifications contact PS Industries, 1150 S. 48th Street, Grand Forks, ND 58201, phone 877-446-1519, email: [4psinfo@psindustries.com](mailto:4psinfo@psindustries.com).

**Claim Procedure:** To make a claim under this Limited Warranty, the claim must be received by PS Industries before the expiration of the above stated Limited Warranty period together with proof of purchase. Contact PS Industries at the address shown below.

PS Industries Incorporated	Toll Free: 877-446-1519
Attention: Warranty	Phone: 701-746-4519
1150 S. 48th Street	Fax: 701-746-8340
Grand Forks, ND 58201	E-mail: <a href="mailto:4psinfo@psindustries.com">4psinfo@psindustries.com</a>

An authorized PS Industries representative must be given a reasonable opportunity to inspect and investigate the alleged Product defect prior to any work being done that affects the Product or its installation. PS Industries reserves the right to charge reasonable amounts for travel and labor associated with investigation of claims. PS Industries may also require photographs of the alleged Product defect or return of the Product or part to a designated PS Industries location, freight prepaid. A return goods authorization must be received prior to the return of the Product or part. Please contact PS Industries to determine the designated location for return and to obtain the return material authorization.

**Exclusive Remedy:** In the event of a warranty claim that PS Industries determines to be covered by this Limited Warranty, PS Industries will replace or repair, at PS Industries' discretion, the Product or any part of the Product found to be defective.

**Disclaimers:** The above warranty and remedy is the sole express warranty and remedy given by PS Industries on its Product. No warranties or representations at any time made by any representative from PS Industries shall vary or expand the provisions hereof. TO THE EXTENT PERMITTED BY LAW, ALL EXPRESS AND IMPLIED WARRANTIES (INCLUDING IMPLIED WARRANTIES OF MERCHANTABILITY, FITNESS FOR A PARTICULAR PURPOSE AND NON-INFRINGEMENT) OTHER THAN THE EXPRESS LIMITED WARRANTY SET FORTH ABOVE ARE EXPRESSLY DISCLAIMED. UPON THE EXPIRATION OF THE ABOVE STATED LIMITED WARRANTY PERIOD, ANY AND ALL APPLICABLE IMPLIED WARRANTIES, INCLUDING, WITHOUT LIMITATION, WARRANTIES OF MERCHANTABILITY, FITNESS FOR A PARTICULAR PURPOSE AND NON-INFRINGEMENT, ARE DISCLAIMED. SOME STATES DO NOT ALLOW LIMITATION ON HOW LONG AN IMPLIED WARRANTY LASTS, SO THE ABOVE LIMITATION MAY NOT APPLY TO OWNER.

**LIABILITY LIMITATION:** In no event will PS Industries' liability to Owner or any other person or entity exceed the price paid to PS Industries for the defective Product. IN NO EVENT SHALL PS INDUSTRIES BE LIABLE TO OWNER OR ANY OTHER PERSON OR ENTITY FOR INCIDENTAL, CONSEQUENTIAL, INDIRECT OR SPECIAL DAMAGES OF ANY DESCRIPTION, WHETHER ARISING OUT OF WARRANTY (INCLUDING ANY IMPLIED WARRANTIES) OR ANY OTHER CONTRACT, STRICT LIABILITY, NEGLIGENCE OR OTHER TORT, OR OTHERWISE, INCLUDING ARISING FROM INSPECTION OR REMEDY DELAYS. SOME STATES DO NOT ALLOW THE EXCLUSION OR LIMITATION OF INCIDENTAL OR CONSEQUENTIAL DAMAGES, SO THE ABOVE LIMITATION AND EXCLUSION MAY NOT APPLY TO OWNER.

THIS WARRANTY GIVES OWNER SPECIFIC LEGAL RIGHTS AND OWNER MAY ALSO HAVE OTHER RIGHTS, WHICH VARY FROM STATE TO STATE.





**877.446.1519**

**4psinfo@psindustries.com | pssafetyaccess.com**  
**1150 South 48th Street | Grand Forks, ND 58201**

**Product Registration:**  
**[psindustries.com/contact/register-your-product](https://psindustries.com/contact/register-your-product)**